

PCB-mountable

→ GA1 and GA8

- PCB-mountable (flat pack = GA1, SIP = GA8)
- Rating : 4 A-5 A
- Peak voltage : 600 V
- Will withstand a 1-cycle 100 A surge
- TRIAC outputs
- UL - cUL 3 A approval and CE marking
- Zero voltage or instantaneous switching (5A only)
- Input to output insulation voltage : 4000 V
- Protection by RC filter



Specifications

Type	Current	Input voltage	Switching	Code
GA1 range	4 A	3 - 32 V DC	Zero voltage	84 064 131
GA8 range	3 A	3 - 32 V DC	Instantaneous	84 025 040
		3 - 32 V DC	Zero voltage	84 065 040
	4 A	3 - 32 V DC	Zero voltage	84 065 131
	5 A	3 - 32 V DC	Instantaneous	84 025 030
		3 - 32 V DC	Zero voltage	84 065 030

General characteristics

Output characteristics

Voltage range V (rms) max	24-280 / 24-480
Peak voltage (1 min) V(peak)	24-280 : 600 24-480 : 850
Maximum current A(rms)	24-280 : 4 or 5 depending on part no. 24-480 : 3
Minimum current mA(rms)	0.05
Max. 1-cycle surge (Apeak)	100
Max. leakage current (mAeff)	6
On-state voltage drop at I _{max} and T = 25 °C V(peak)	24-280 : 1.6 24-480 : 1.65
Static (off-state) dv/dt (V/μs)	200
Response time (close) (cycle)	0.5
Frequency (Hz)	47 → 63

Inputs specifications

Input voltage	3-32 V DC
Turn-off voltage (V)	1 V DC
Max input current	25 mA (at V _{max})
Nominal input resistance (kΩ)	regulated

Characteristics

Operating temperature (°C)	-30 → +80
Storage temperature (°C)	-40 → +100
Input to output insulation voltage V(rms)	4000 V _{rms}
Input/output capacitance (pF)	8
Weight (g)	15

To order, see page 6

For more information www.crouzet.com

Dimensions

GA1

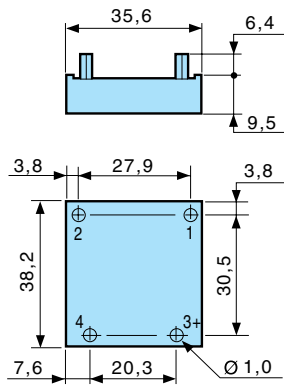

General tolerances ± 0.5

GA8

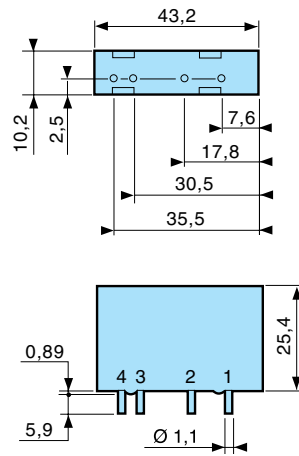

General tolerances ± 0.5

Connections

Equivalent circuits

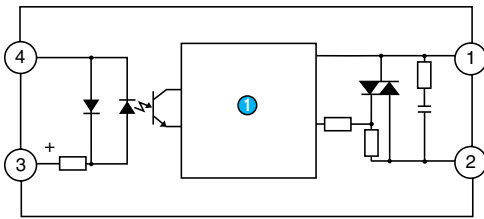

① Matching and trigger circuit (zero voltage)

Curves

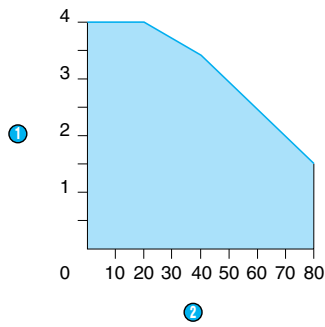

- ① Rating (Vpeak)
- ② Ambient temperature

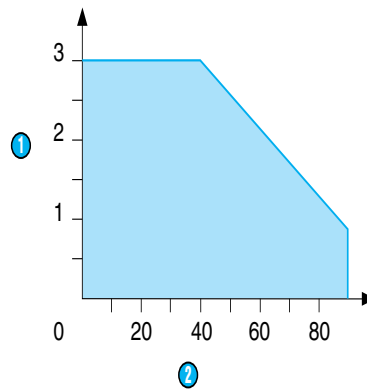

- ① Rating (Vpeak)
- ② Ambient temperature (°C)